

The logo for IDEMA, featuring the word "IDEMA" in a bold, blue, sans-serif font. The letter "I" has a small orange square above it. The logo is centered between two horizontal, rounded blue bars of varying thickness.

Catálogo Geral de Engrenagens para Correntes de Transmissão

Linha Standard



Tipos de Engrenagens



A = Furo Piloto
 B = Furo Máximo Recomendável
 D = Diâmetro do Cubo
 L = Comprimento
 t = Espessura do Dentado

ASA = A
 DIN = B

Exemplo:
 Engrenagem → 2.60.35 BT5
 2 = duas carreiras
 60 = passo 19,05 (3/4")
 35 = nº de dentes
 B = Norma DIN
 T5 = tipo 5

Tipo 1

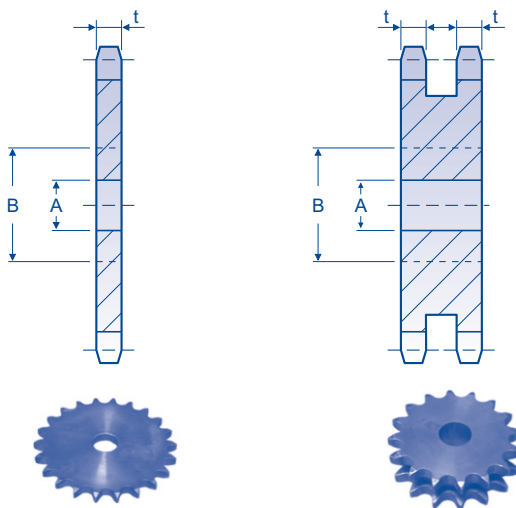

Tipo 2

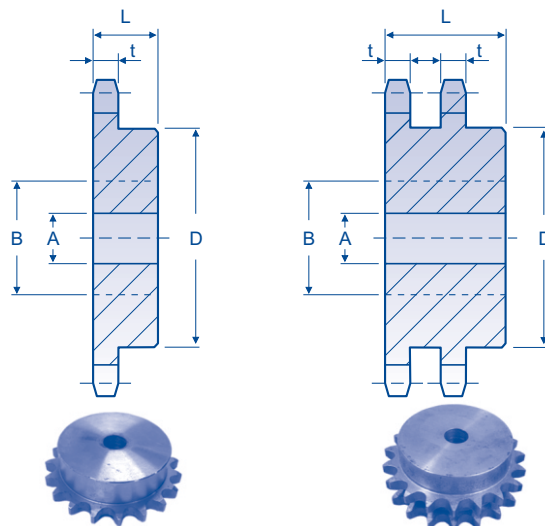

Tipo 3

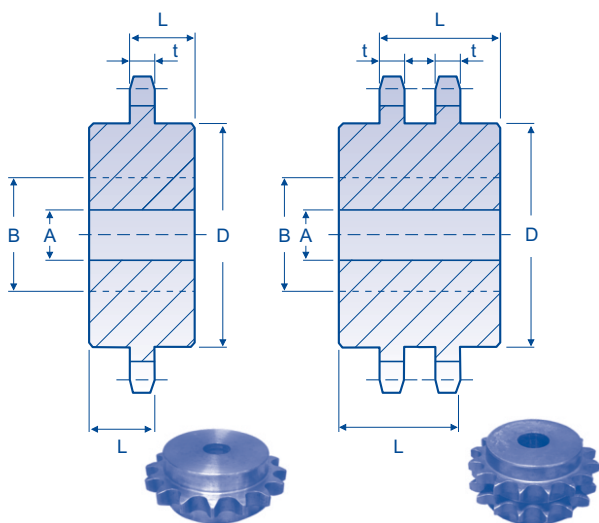

Tipo 4

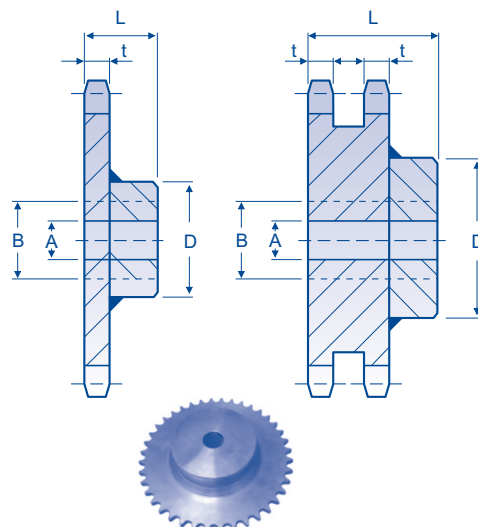

Tipo 5

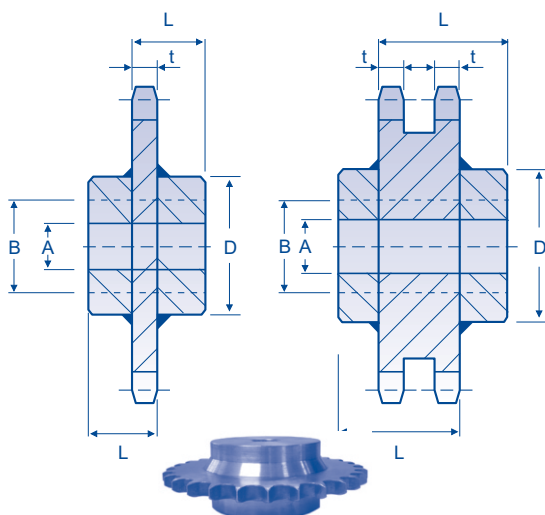

NÚMERO DE CARREIRAS

Simplex = 1
 Dupla = 2
 Tripla = 3
 Quádrupla = 4

PASSOS

9,525 = 35	19,050 = 60	38,100 = 120
12,700 = 40	25,400 = 80	44,450 = 140
15,875 = 50	31,750 = 100	50,80 = 160
PASSO LONGO 25,4 = 2040		
PASSO LONGO 31,75 = 2050		
PASSO LONGO 38,1 = 2060		

Engrenagens Passo 6,35mm - 1/4"



Norma ASA 25

Corrente:

Largura interna: 3,18

Diâmetro do rolo: 3,30

Engrenagem:

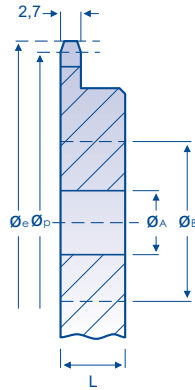

Nº de dentes Z	Diâmetro Primitivo Ø _p	Diâmetro Externo Ø _e	Ø _A	Ø _B	Ø _D	Simples		Nº de dentes Z	Diâmetro Primitivo Ø _p	Diâmetro Externo Ø _e	Ø _A	Ø _B	Ø _D	Simples	
						L	Tipos							L	Tipos
010	20,55	23,0	6,5	8,5	14	15	2-3	021	42,61	46,0	9,5	16	30	20	2-3
011	22,54	25,0	6,5	8,5	16	15	2-3	022	44,62	48,0	9,5	16	30	20	2-3
012	24,53	28,0	7,5	9,5	18	15	2-3	023	46,63	50,0	9,5	16	30	20	2-3
013	26,53	30,0	7,5	10	20	20	2-3	024	48,65	52,0	9,5	16	30	20	2-3
014	28,54	32,0	7,5	10	20	20	2-3	025	50,66	54,0	9,5	20	35	20	2-3
015	30,54	34,0	7,5	10	20	20	2-3	026	52,68	56,0	9,5	20	40	20	2-3
016	32,55	36,0	9,5	12	25	20	2-3	027	54,70	58,0	9,5	20	40	20	2-3
017	34,56	38,0	9,5	12	25	20	2-3	028	56,71	60,0	9,5	20	40	20	2-3
018	36,57	40,0	9,5	12	25	20	2-3	030	60,75	64,0	9,5	20	45	20	2-3
019	38,58	42,0	9,5	16	25	20	2-3	033	66,80	70,0	10,5	22	50	25	2-3
020	40,59	44,0	9,5	16	25	20	2-3	035	70,84	74,0	10,5	22	50	25	2-3

Corrente:

Largura interna: 4,77

Diâmetro do rolo: 5,08

Engrenagens:

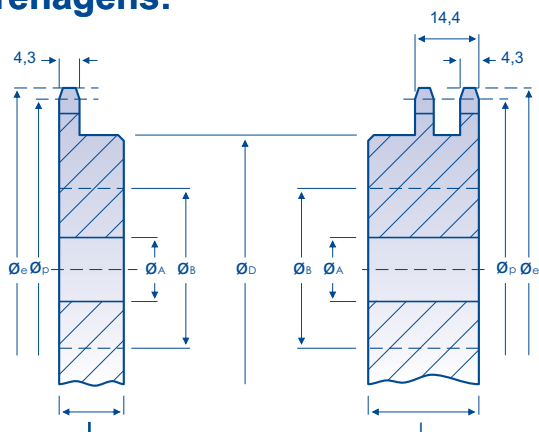

Corrente:

Largura interna: 5,72

Diâmetro do rolo: 6,35

Engrenagens:

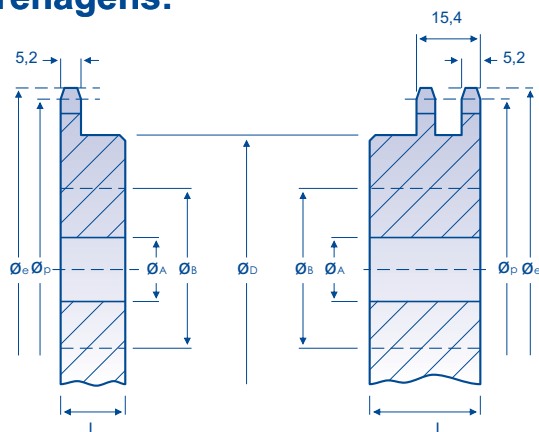

Nº de dentes Z	Diâmetro Primitivo Ø _p	Diâmetro Externo Ø _e	Ø _A	Ø _B	Ø _D	Simples		Dupla		Nº de dentes Z	Diâmetro Primitivo Ø _p	Diâmetro Externo Ø _e	Ø _A	Ø _B	Ø _D	Simples		Dupla	
						L	Tipos	L	Tipos							L	Tipos	L	Tipos
010	30,82	34,0	12	13	20	16	2-3	22	2-3	050	151,69	157,0	20	90	135	25	2-3	30	2-3
011	33,81	37,0	12	15	23	16	2-3	22	2-3	051	154,72	160,0	20	90	135	25	2-3	30	2-3
012	36,80	40,0	12	17	26	16	2-3	22	2-3	052	157,75	163,0	20	90	135	25	2-3	30	2-3
013	39,80	44,0	12	19	29	16	2-3	22	2-3	053	160,78	166,0	20	90	135	25	2-3	30	2-3
014	42,81	47,0	12	21	32	16	2-3	22	2-3	054	163,81	169,0	20	48	72	30	4-5	35	4-5
015	45,81	50,0	12	23	35	20	2-3	25	2-3	055	166,84	172,0	20	48	72	30	4-5	35	4-5
016	48,82	53,0	12	25	38	20	2-3	25	2-3	056	169,88	175,0	20	48	72	30	4-5	35	4-5
017	51,84	56,0	12	27	41	20	2-3	25	2-3	057	172,91	178,0	20	48	72	30	4-5	35	4-5
018	54,85	59,0	12	29	44	20	2-3	25	2-3	058	175,94	181,0	20	48	72	30	4-5	35	4-5
019	57,87	62,0	12	31	47	22	2-3	25	2-3	059	178,97	184,0	20	48	72	30	4-5	35	4-5
020	60,89	65,0	12	33	50	22	2-3	25	2-3	060	182,00	187,0	20	57	80	30	4-5	35	4-5
021	63,91	68,0	12	35	53	22	2-3	25	2-3	061	185,03	190,0	20	57	80	30	4-5	35	4-5
022	66,93	71,0	12	37	56	22	2-3	25	2-3	062	188,06	193,0	20	57	80	30	4-5	35	4-5
023	69,95	74,0	12	39	59	22	2-3	25	2-3	063	191,09	196,0	20	57	80	30	4-5	35	4-5
024	72,97	77,0	15	41	62	22	2-3	25	2-3	064	194,12	199,0	20	57	80	30	4-5	35	4-5
025	76,00	80,0	15	43	65	22	2-3	25	2-3	065	197,15	202,0	20	57	80	30	4-5	35	4-5
026	79,02	84,0	15	45	68	22	2-3	25	2-3	066	200,18	205,0	20	57	80	30	4-5	35	4-5
027	82,05	87,0	15	47	70	22	2-3	25	2-3	067	203,21	208,0	20	57	80	30	4-5	35	4-5
028	85,07	90,0	15	48	72	22	2-3	25	2-3	068	206,24	211,0	20	57	80	30	4-5	35	4-5
029	88,10	93,0	15	50	75	22	2-3	25	2-3	069	209,27	214,0	20	57	80	30	4-5	35	4-5
030	91,12	96,0	15	52	78	25	2-3	30	2-3	070	212,30	217,0	20	57	80	30	4-5	35	4-5
031	94,15	99,0	15	54	80	25	2-3	30	2-3	071	215,33	220,0	20	57	80	30	4-5	35	4-5
032	97,18	102,0	15	56	84	25	2-3	30	2-3	072	218,37	223,0	20	57	80	30	4-5	35	4-5
033	100,20	105,0	15	58	87	25	2-3	30	2-3	073	221,40	226,0	20	57	80	30	4-5	35	4-5
034	103,23	108,0	15	60	90	25	2-3	30	2-3	074	224,43	229,0	20	57	80	30	4-5	35	4-5
035	106,26	111,0	15	62	93	25	2-3	30	2-3	075	227,46	232,0	20	57	80	30	4-5	35	4-5
036	109,29	114,0	15	64	96	25	2-3	30	2-3	076	230,49	235,0	20	57	80	30	4-5	35	4-5
037	112,32	117,0	15	67	100	25	2-3	30	2-3	077	233,52	238,0	20	57	80	30	4-5	35	4-5
038	115,34	120,0	15	69	103	25	2-3	30	2-3	078	236,55	241,0	20	57	80	30	4-5	35	4-5
039	118,37	123,0	15	71	107	25	2-3	30	2-3	079	239,58	244,0	20	57	80	30	4-5	35	4-5
040	121,40	126,0	15	73	110	25	2-3	30	2-3	080	242,61	247,0	20	57	80	30	4-5	35	4-5
041	124,43	129,0	15	75	113	25	2-3	30	2-3	081	245,65	250,0	20	57	80	30	4-5	35	4-5
042	127,46	132,0	15	77	116	25	2-3	30	2-3	082	248,68	254,0	20	57	80	30	4-5	35	4-5
043	130,49	135,0	15	80	120	25	2-3	30	2-3	083	251,71	257,0	20	57	80	30	4-5	35	4-5
044	133,52	138,0	15	82	123	25	2-3	30	2-3	084	254,74	260,0	20	57	80	30	4-5	35	4-5
045	136,55	141,0	20	82	126	25	2-3	30	2-3	085	257,77	263,0	20	57	80	30	4-5	35	4-5
046	139,58	144,0	20	82	126	25	2-3	30	2-3	090	272,93	278,0	20	57	80	30	4-5	35	4-5
047	142,61	147,0	20	82	126	25	2-3	30	2-3	095	288,08	293,0	20	57	80	30	4-5	35	4-5
048	145,63	150,0	20	87	130	25	2-3	30	2-3	100	303,24	308,0	20	57	80	30	4-5	35	4-5
049	148,66	154,0	20	87	130	25	2-3	30	2-3	114	345,68	351,0	20	65	98	30	4-5	35	4-5

Engrenagens Passo 12,70mm - 1/ 2"



Norma ASA 40

Norma DIN 40 = 08B

Corrente:

Largura interna: 7,95

Diâmetro do rolo: 7,94

Corrente:

Largura interna: 7,75

Diâmetro do rolo: 8,51

Engrenagens:

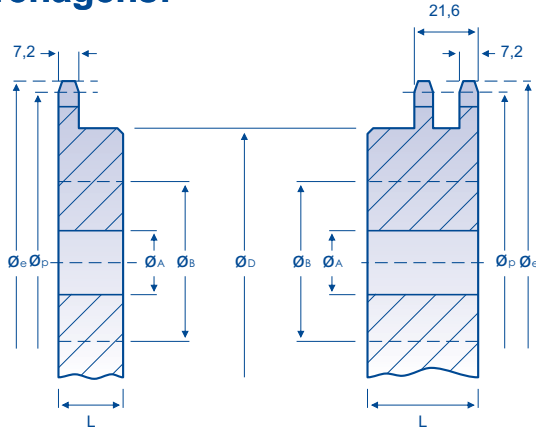

Engrenagens:

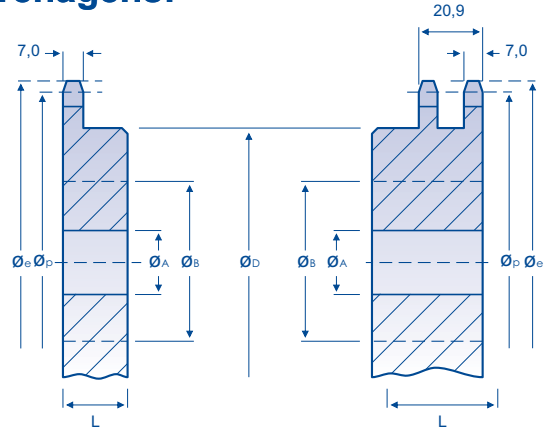

Nº de dentes Z	Diâmetro Primitivo Ø _p	Diâmetro Externo Ø _e	Ø _A	Ø _B	Ø _D	Simples		Dupla		Nº de dentes Z	Diâmetro Primitivo Ø _p	Diâmetro Externo Ø _e	Ø _A	Ø _B	Ø _D	Simples		Dupla	
						L	Tipos	L	Tipos							L	Tipos	L	Tipos
009	37,13	42,0	12	15	22	25	2-3	30	2-3	048	194,18	200,0	25	57	86	36	4-5	46	4-5
010	41,10	46,0	12	17	26	25	2-3	30	2-3	049	198,22	204,0	25	57	86	36	4-5	46	4-5
011	45,08	50,0	12	20	30	25	2-3	30	2-3	050	202,26	208,0	25	57	86	36	4-5	46	4-5
012	49,07	54,0	12	23	34	25	2-3	30	2-3	051	206,30	213,0	25	57	86	36	4-5	46	4-5
013	53,07	58,0	12	26	39	25	2-3	30	2-3	052	210,34	217,0	25	57	86	36	4-5	46	4-5
014	57,07	62,0	12	29	43	25	2-3	30	2-3	053	214,38	221,0	25	57	86	36	4-5	46	4-5
015	61,08	66,0	12	31	47	25	2-3	30	2-3	054	218,42	225,0	25	57	86	36	4-5	46	4-5
016	65,10	71,0	17	34	51	25	2-3	30	2-3	055	222,46	229,0	25	57	86	36	4-5	46	4-5
017	69,12	75,0	17	37	55	25	2-3	30	2-3	056	226,50	233,0	25	57	86	36	4-5	46	4-5
018	73,14	79,0	17	39	59	25	2-3	30	2-3	057	230,54	237,0	25	65	98	36	4-5	46	4-5
019	77,16	83,0	17	42	63	25	2-3	30	2-3	058	234,58	241,0	25	65	98	36	4-5	46	4-5
020	81,18	87,0	17	45	67	25	2-3	30	2-3	059	238,62	245,0	25	65	98	36	4-5	46	4-5
021	85,21	91,0	17	47	71	25	2-3	30	2-3	060	242,66	249,0	25	65	98	36	4-5	50	4-5
022	89,24	95,0	17	50	75	30	2-3	36	2-3	061	246,70	253,0	25	65	98	36	4-5	50	4-5
023	93,27	99,0	17	53	79	30	2-3	36	2-3	062	250,74	257,0	25	65	98	36	4-5	50	4-5
024	97,30	103,0	17	55	83	30	2-3	36	2-3	063	254,78	261,0	25	65	98	36	4-5	50	4-5
025	101,33	107,0	17	58	87	30	2-3	36	2-3	064	258,83	265,0	25	65	98	36	4-5	50	4-5
026	105,36	112,0	17	61	92	30	2-3	36	2-3	065	262,87	269,0	25	65	98	36	4-5	50	4-5
027	109,40	116,0	17	63	95	30	2-3	36	2-3	066	266,91	273,0	25	65	98	36	4-5	50	4-5
028	113,43	120,0	17	63	95	30	2-3	36	2-3	067	270,95	277,0	25	65	98	36	4-5	50	4-5
029	117,46	124,0	17	63	95	30	2-3	36	2-3	068	274,99	281,0	25	65	98	36	4-5	50	4-5
030	121,50	128,0	17	67	100	30	2-3	36	2-3	069	279,03	285,0	25	65	98	36	4-5	50	4-5
031	125,53	132,0	20	67	100	30	2-3	36	2-3	070	283,07	289,0	25	65	98	36	4-5	50	4-5
032	129,57	136,0	20	67	100	30	2-3	36	2-3	071	287,11	293,0	25	65	98	36	4-5	50	4-5
033	133,61	140,0	20	67	100	30	2-3	36	2-3	072	291,15	297,0	25	65	98	36	4-5	50	4-5
034	137,64	144,0	20	67	100	30	2-3	36	2-3	073	295,20	301,0	25	65	98	36	4-5	50	4-5
035	141,68	148,0	20	57	86	32	4-5	-	-	074	299,24	305,0	25	65	98	36	4-5	50	4-5
035	141,68	148,0	20	67	100	-	-	36	2-3	075	303,28	310,0	25	65	98	36	4-5	50	4-5
036	145,72	152,0	20	57	86	32	4-5	41	4-5	076	307,32	314,0	25	65	98	36	4-5	50	4-5
037	149,75	156,0	20	57	86	32	4-5	41	4-5	077	311,36	318,0	25	65	98	36	4-5	50	4-5
038	153,79	160,0	20	57	86	32	4-5	41	4-5	078	315,40	322,0	25	65	98	36	4-5	50	4-5
039	157,83	164,0	20	57	86	32	4-5	41	4-5	079	319,40	326,0	25	65	98	36	4-5	50	4-5
040	161,87	168,0	20	57	86	36	4-5	46	4-5	080	323,49	330,0	25	65	98	36	4-5	50	4-5
041	165,91	172,0	20	57	86	36	4-5	46	4-5	081	327,53	334,0	25	65	98	36	4-5	50	4-5
042	169,94	176,0	20	57	86	36	4-5	46	4-5	082	331,57	338,0	25	65	98	36	4-5	50	4-5
043	173,98	180,0	20	57	86	36	4-5	46	4-5	085	343,69	350,0	25	65	98	36	4-5	50	4-5
044	178,02	184,0	20	57	86	36	4-5	46	4-5	090	363,90	370,0	25	65	98	36	4-5	50	4-5
045	182,06	188,0	20	57	86	36	4-5	46	4-5	095	384,11	390,0	25	65	98	36	4-5	50	4-5
046	186,10	192,0	20	57	86	36	4-5	46	4-5	100	404,32	411,0	25	65	98	36	4-5	50	4-5
047	190,14	196,0	20	57	86	36	4-5	46	4-5	114	460,91	467,0	25	73	110	36	4-5	50	4-5

Corrente:

Largura interna: 9,53

Diâmetro do rolo: 10,16

Engrenagens:

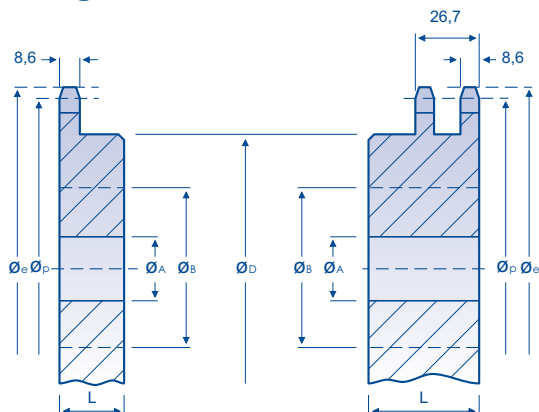

Corrente:

Largura interna: 9,65

Diâmetro do rolo: 10,16

Engrenagens:

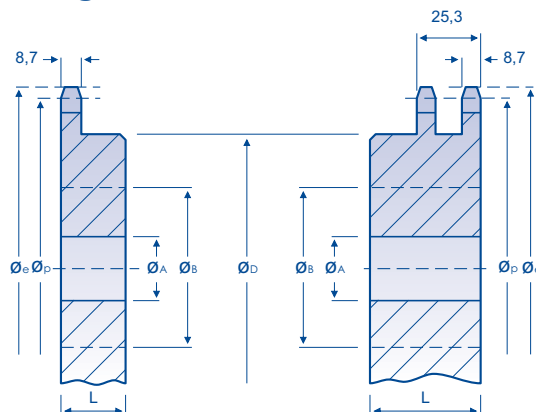

Nº de dentes Z	Diâmetro Primitivo Ø _p	Diâmetro Externo Ø _e	Ø _A	Ø _B	Ø _D	Simples		Dupla		Nº de dentes Z	Diâmetro Primitivo Ø _p	Diâmetro Externo Ø _e	Ø _A	Ø _B	Ø _D	Simples		Dupla	
						L	Tipos	L	Tipos							L	Tipos	L	Tipos
008	41,48	47,0	12	14	21	25	2-3	45	2-3	042	212,43	220,0	25	57	86	40	4-5	55	4-5
009	46,42	52,0	15	19	28	25	2-3	45	2-3	043	217,48	225,0	25	57	86	40	4-5	55	4-5
010	51,37	57,0	15	22	33	25	2-3	45	2-3	044	222,53	230,0	25	57	86	40	4-5	55	4-5
011	56,35	62,0	15	25	38	25	2-3	45	2-3	045	227,58	235,0	25	57	86	40	4-5	55	4-5
012	61,34	67,0	15	29	44	25	2-3	45	2-3	046	232,63	240,0	25	57	86	40	4-5	55	4-5
013	66,34	73,0	15	32	48	25	2-3	45	2-3	047	237,68	245,0	25	57	86	40	4-5	55	4-5
014	71,34	78,0	17	35	53	25	2-3	45	2-3	048	242,73	250,0	25	65	98	40	4-5	55	4-5
015	76,36	83,0	17	39	59	25	2-3	45	2-3	049	247,77	255,0	25	65	98	40	4-5	55	4-5
016	81,37	88,0	17	43	64	25	2-3	45	2-3	050	252,82	260,0	25	65	98	40	4-5	55	4-5
017	86,40	93,0	17	46	69	25	2-3	45	2-3	051	257,87	265,0	25	65	98	40	4-5	55	4-5
018	91,42	98,0	17	49	74	25	2-3	45	2-3	052	262,92	270,0	25	65	98	40	4-5	55	4-5
019	96,45	103,0	17	53	79	30	2-3	45	2-3	053	267,97	275,0	25	65	98	40	4-5	55	4-5
020	101,48	108,0	20	56	84	30	2-3	45	2-3	054	273,03	280,0	25	65	98	40	4-5	55	4-5
021	106,51	113,0	20	59	89	30	2-3	45	2-3	055	278,08	286,0	25	65	98	40	4-5	55	4-5
022	111,55	118,0	20	63	94	30	2-3	45	2-3	056	283,13	291,0	25	65	98	40	4-5	55	4-5
023	116,59	123,0	20	66	99	30	2-3	45	2-3	057	288,18	296,0	25	65	98	40	4-5	55	4-5
024	121,62	128,0	20	67	100	34	2-3	45	2-3	058	293,23	301,0	25	65	98	40	4-5	55	4-5
025	126,66	133,0	20	67	100	34	2-3	45	2-3	059	298,28	306,0	25	65	98	40	4-5	55	4-5
026	131,70	139,0	20	73	110	34	2-3	45	2-3	060	303,33	311,0	25	65	98	40	4-5	55	4-5
027	136,74	144,0	20	73	110	34	2-3	45	2-3	061	308,33	316,0	25	65	98	40	4-5	55	4-5
028	141,79	149,0	20	57	86	37	4-5	-	-	062	313,43	321,0	25	65	98	40	4-5	55	4-5
028	141,79	149,0	20	73	110	-	-	51	2-3	063	318,48	326,0	25	65	98	40	4-5	55	4-5
029	146,83	154,0	20	57	86	37	4-5	-	-	064	323,53	331,0	25	65	98	40	4-5	55	4-5
029	146,83	154,0	20	73	110	-	-	51	2-3	065	328,58	336,0	25	65	98	40	4-5	55	4-5
030	151,87	159,0	20	57	86	37	4-5	-	-	066	333,63	341,0	25	65	98	40	4-5	55	4-5
030	151,87	159,0	20	73	110	-	-	51	2-3	067	338,69	346,0	25	65	98	40	4-5	55	4-5
031	156,92	164,0	20	57	86	37	4-5	-	-	068	343,74	351,0	25	65	98	40	4-5	55	4-5
031	156,92	164,0	20	73	110	-	-	51	2-3	069	348,79	356,0	25	65	98	40	4-5	55	4-5
032	161,96	169,0	20	57	86	37	4-5	-	-	070	353,84	361,0	25	65	98	40	4-5	55	4-5
032	161,96	169,0	20	73	110	-	-	51	2-3	071	358,89	366,0	25	65	98	40	4-5	55	4-5
033	167,01	175,0	20	57	86	37	4-5	-	-	072	363,94	371,0	25	65	98	40	4-5	55	4-5
033	167,01	175,0	20	73	110	-	-	51	2-3	073	368,99	376,0	25	65	98	40	4-5	55	4-5
034	172,05	180,0	20	57	86	37	4-5	51	4-5	074	374,05	382,0	25	65	98	40	4-5	55	4-5
035	177,10	185,0	20	57	86	37	4-5	51	4-5	075	379,10	387,0	25	65	98	40	4-5	55	4-5
036	182,14	190,0	20	57	86	37	4-5	51	4-5	076	384,15	392,0	30	65	98	40	4-5	55	4-5
037	187,19	195,0	20	57	86	37	4-5	51	4-5	080	404,36	412,0	30	65	98	40	4-5	55	4-5
038	192,24	200,0	25	57	86	37	4-5	51	4-5	085	429,62	437,0	30	65	98	40	4-5	55	4-5
039	197,29	205,0	25	57	86	37	4-5	51	4-5	090	454,88	462,0	30	65	98	40	4-5	55	4-5
040	202,33	210,0	25	57	86	40	4-5	55	4-5	095	480,14	488,0	30	73	110	40	4-5	55	4-5
041	207,38	215,0	25	57	86	40	4-5	55	4-5	114	576,13	584,0	30	73	110	40	4-5	55	4-5

Engrenagens Passo 19,05mm - 3/4"



Norma ASA 60

Norma DIN 60 = 12B

Corrente:

Largura interna: 12,70

Diâmetro do rolo: 11,90

Engrenagens:

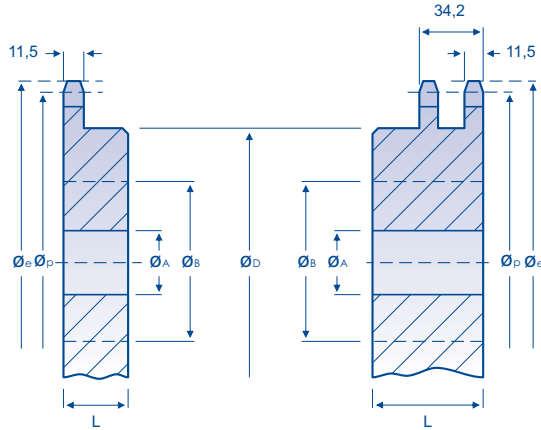

Corrente:

Largura interna: 11,68

Diâmetro do rolo: 12,07

Engrenagens:

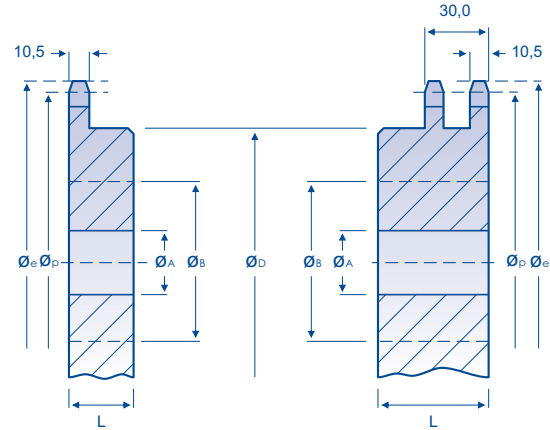

Nº de dentes Z	Diâmetro Primitivo Ø _p	Diâmetro Externo Ø _e	Ø _A	Ø _B	Ø _D	Simples		Dupla		Nº de dentes Z	Diâmetro Primitivo Ø _p	Diâmetro Externo Ø _e	Ø _A	Ø _B	Ø _D	Simples		Dupla	
						L	Tipos	L	Tipos							L	Tipos	L	Tipos
008	49,78	56,0	15	17	26	30	2-3	45	2-3	041	248,86	258,0	30	65	98	45	4-5	-	-
009	55,70	62,0	15	22	33	30	2-3	45	2-3	041	248,86	258,0	30	73	110	-	-	65	4-5
010	61,65	68,0	15	26	39	30	2-3	45	2-3	042	254,96	264,0	30	65	98	45	4-5	-	-
011	67,62	74,0	20	31	46	30	2-3	45	2-3	042	254,96	264,0	30	73	110	-	-	65	4-5
012	73,60	80,0	20	35	52	30	2-3	45	2-3	043	260,98	270,0	30	65	98	45	4-5	-	-
013	79,60	87,0	20	39	58	30	2-3	45	2-3	043	260,98	270,0	30	73	110	-	-	65	4-5
014	85,61	93,0	20	43	64	30	2-3	45	2-3	044	267,03	276,0	30	65	98	45	4-5	-	-
015	91,63	99,0	20	47	70	30	2-3	45	2-3	044	267,03	276,0	30	73	110	-	-	65	4-5
016	97,65	105,0	20	51	77	30	2-3	45	2-3	045	273,09	282,0	30	73	110	45	4-5	65	4-5
017	103,67	111,0	20	56	83	30	2-3	45	2-3	046	279,15	288,0	30	73	110	45	4-5	65	4-5
018	109,71	117,0	20	60	90	30	2-3	45	2-3	047	285,21	294,0	30	73	110	45	4-5	65	4-5
019	115,74	123,0	20	64	96	36	2-3	50	2-3	048	291,27	300,0	30	83	124	45	4-5	65	4-5
020	121,78	129,0	20	67	100	36	2-3	50	2-3	049	297,33	306,0	30	83	124	45	4-5	65	4-5
021	127,82	135,0	25	71	107	36	2-3	50	2-3	050	303,39	312,0	30	83	124	45	4-5	65	4-5
022	133,86	141,0	25	75	113	36	2-3	50	2-3	051	309,45	318,0	30	83	124	45	4-5	65	4-5
023	139,90	147,0	25	75	113	36	2-3	50	2-3	052	315,51	324,0	30	83	124	45	4-5	65	4-5
024	145,95	153,0	25	65	98	39	4-5	-	-	053	321,57	330,0	30	83	124	45	4-5	65	4-5
024	145,95	153,0	25	77	115	-	-	58	2-3	054	327,63	336,0	30	83	124	45	4-5	65	4-5
025	151,99	160,0	25	65	98	39	4-5	-	-	055	333,69	342,0	30	83	124	45	4-5	65	4-5
025	151,99	160,0	25	77	115	-	-	58	2-3	056	339,75	348,0	30	83	124	45	4-5	65	4-5
026	158,04	167,0	25	65	98	39	4-5	-	-	057	345,81	355,0	30	83	124	45	4-5	65	4-5
026	158,04	167,0	25	80	120	-	-	58	2-3	058	351,87	361,0	30	83	124	45	4-5	65	4-5
027	164,09	173,0	25	65	98	39	4-5	-	-	059	357,93	367,0	30	83	124	45	4-5	65	4-5
027	164,09	173,0	25	80	120	-	-	58	2-3	060	363,99	373,0	30	83	124	45	4-5	65	4-5
028	170,14	179,0	25	65	98	39	4-5	58	4-5	061	370,05	379,0	30	83	124	45	4-5	65	4-5
029	176,19	185,0	25	65	98	39	4-5	58	4-5	062	376,12	385,0	30	83	124	45	4-5	65	4-5
030	182,25	191,0	25	65	98	39	4-5	58	4-5	063	382,18	391,0	30	83	124	45	4-5	65	4-5
031	188,30	197,0	25	65	98	39	4-5	58	4-5	064	388,24	397,0	30	83	124	45	4-5	65	4-5
032	194,35	203,0	25	65	98	39	4-5	58	4-5	065	394,30	403,0	30	83	124	45	4-5	65	4-5
033	200,41	209,0	25	65	98	39	4-5	58	4-5	066	400,36	409,0	30	83	124	45	4-5	65	4-5
034	206,46	215,0	25	65	98	39	4-5	58	4-5	067	406,42	415,0	30	83	124	45	4-5	65	4-5
035	212,52	221,0	25	65	98	39	4-5	58	4-5	068	412,48	421,0	30	83	124	45	4-5	65	4-5
036	218,57	227,0	25	65	98	39	4-5	58	4-5	069	418,55	427,0	30	83	124	45	4-5	65	4-5
037	224,63	233,0	25	65	98	39	4-5	58	4-5	070	424,61	433,0	30	83	124	45	4-5	65	4-5
038	230,69	239,0	30	65	98	45	4-5	-	-	076	460,98	470,0	30	83	124	45	4-5	65	4-5
038	230,69	239,0	30	73	110	-	-	65	4-5	080	485,23	494,0	30	83	124	45	4-5	65	4-5
039	236,74	246,0	30	65	98	45	4-5	-	-	085	515,54	524,0	30	83	124	45	4-5	65	4-5
039	236,74	246,0	30	73	110	-	-	65	4-5	090	545,85	555,0	30	83	124	45	4-5	65	4-5
040	242,80	252,0	30	65	98	45	4-5	-	-	095	576,16	585,0	30	90	136	45	4-5	65	4-5
040	242,80	252,0	30	73	110	-	-	65	4-5	114	691,36	700,0	30	100	150	45	4-5	65	4-5

Corrente:

Largura interna: 15,88

Diâmetro do rolo: 15,87

Engrenagens:

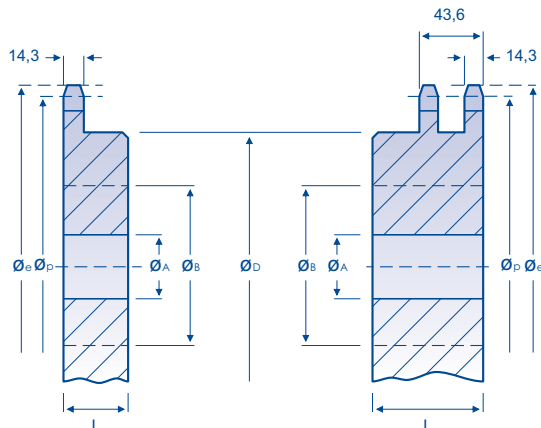

Corrente:

Largura interna: 17,02

Diâmetro do rolo: 15,88

Engrenagens:

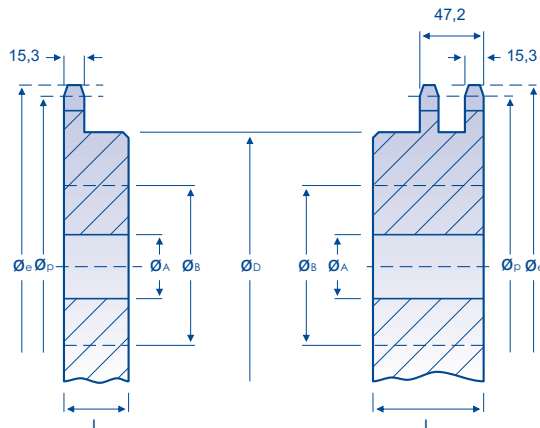

Nº de dentes Z	Diâmetro Primitivo Ø _p	Diâmetro Externo Ø _e	Ø _A	Ø _B	Ø _D	Simples		Dupla		Nº de dentes Z	Diâmetro Primitivo Ø _p	Diâmetro Externo Ø _e	Ø _A	Ø _B	Ø _D	Simples		Dupla	
						L	Tipos	L	Tipos							L	Tipos	L	Tipos
008	66,37	75,0	20	24	36	35	2-3	60	2-3	039	315,66	327,0	30	73	110	45	4-5	72	4-5
009	74,26	83,0	20	30	45	35	2-3	60	2-3	040	323,73	335,0	30	73	110	50	4-5	75	4-5
010	82,20	91,0	20	35	53	35	2-3	60	2-3	041	331,81	343,0	30	73	110	50	4-5	75	4-5
011	90,16	99,0	20	40	61	35	2-3	60	2-3	042	339,89	351,0	30	73	110	50	4-5	75	4-5
012	98,14	106,0	20	45	68	35	2-3	60	2-3	043	347,97	360,0	30	73	110	50	4-5	75	4-5
013	106,14	116,0	20	50	76	35	2-3	60	2-3	044	356,04	368,0	30	73	110	50	4-5	75	4-5
014	114,15	124,0	25	56	84	35	2-3	60	2-3	045	364,12	376,0	30	73	110	50	4-5	75	4-5
015	122,17	132,0	25	61	92	35	2-3	60	2-3	046	372,20	384,0	30	73	110	50	4-5	75	4-5
016	130,20	140,0	25	67	100	35	2-3	60	2-3	047	380,28	392,0	30	73	110	50	4-5	75	4-5
017	138,23	148,0	25	73	110	35	2-3	60	2-3	048	388,36	400,0	30	73	110	50	4-5	75	4-5
018	146,27	156,0	25	65	98	45	4-5	-	-	049	396,44	408,0	30	73	110	50	4-5	75	4-5
018	146,27	156,0	25	77	115	-	-	64	2-3	050	404,52	416,0	30	73	110	50	4-5	75	4-5
019	154,32	164,0	25	65	98	45	4-5	-	-	051	412,60	424,0	30	73	110	50	4-5	75	4-5
019	154,32	164,0	25	77	115	-	-	64	2-3	052	420,68	432,0	30	73	110	50	4-5	75	4-5
020	162,37	172,0	30	65	98	45	4-5	-	-	053	428,76	440,0	30	73	110	50	4-5	75	4-5
020	162,37	172,0	30	80	120	-	-	64	2-3	054	436,84	448,0	30	73	110	50	4-5	75	4-5
021	170,42	180,0	30	65	98	45	4-5	-	-	055	444,92	456,0	30	73	110	50	4-5	75	4-5
021	170,42	180,0	30	80	120	-	-	64	2-3	056	453,00	465,0	30	73	110	50	4-5	75	4-5
022	178,48	188,0	30	73	110	45	4-5	-	-	057	461,08	473,0	35	83	124	50	4-5	75	4-5
022	178,48	188,0	30	80	120	-	-	64	2-3	058	469,16	481,0	35	83	124	50	4-5	75	4-5
023	186,54	197,0	30	73	110	45	4-5	-	-	059	477,24	489,0	35	83	124	50	4-5	75	4-5
023	186,54	197,0	30	80	120	-	-	64	2-3	060	485,32	497,0	35	90	136	50	4-5	75	4-5
024	194,60	205,0	30	73	110	45	4-5	-	-	061	493,41	505,0	35	90	136	50	4-5	75	4-5
024	194,60	205,0	30	83	125	-	-	66	2-3	062	501,49	513,0	35	90	136	50	4-5	75	4-5
025	202,66	213,0	30	73	110	45	4-5	-	-	063	509,57	521,0	35	90	136	50	4-5	75	4-5
025	202,66	213,0	30	83	125	-	-	66	2-3	064	517,65	529,0	35	90	136	50	4-5	75	4-5
026	210,72	222,0	30	73	110	45	4-5	-	-	065	525,73	537,0	35	90	136	50	4-5	75	4-5
026	210,72	222,0	30	83	125	-	-	66	2-3	066	533,82	545,0	35	90	136	50	4-5	75	4-5
027	218,79	230,0	30	73	110	45	4-5	68	4-5	067	541,90	553,0	35	90	136	50	4-5	75	4-5
028	226,86	238,0	30	73	110	45	4-5	68	4-5	068	549,98	562,0	35	90	136	50	4-5	75	4-5
029	234,93	246,0	30	73	110	45	4-5	68	4-5	069	558,06	570,0	35	90	136	50	4-5	75	4-5
030	243,00	255,0	30	73	110	45	4-5	72	4-5	070	566,14	578,0	35	90	136	50	4-5	75	4-5
031	251,07	263,0	30	73	110	45	4-5	72	4-5	071	574,23	586,0	35	90	136	50	4-5	75	4-5
032	259,14	271,0	30	73	110	45	4-5	72	4-5	072	582,31	594,0	35	90	136	50	4-5	75	4-5
033	267,21	279,0	30	73	110	45	4-5	72	4-5	073	590,39	602,0	35	90	136	50	4-5	75	4-5
034	275,28	287,0	30	73	110	45	4-5	72	4-5	074	598,47	610,0	35	90	136	50	4-5	75	4-5
035	283,36	295,0	30	73	110	45	4-5	72	4-5	075	606,56	618,0	35	90	136	50	4-5	75	4-5
036	291,43	303,0	30	73	110	45	4-5	72	4-5	076	614,64	626,0	35	90	136	50	4-5	75	4-5
037	299,51	311,0	30	73	110	45	4-5	72	4-5	090	727,80	739,0	35	90	136	50	4-5	75	4-5
038	307,58	319,0	30	73	110	45	4-5	72	4-5	095	768,22	780,0	35	100	150	50	4-5	75	4-5

Engrenagens Passo 31,75mm - 1 1/4"



Norma ASA 100

Norma DIN 100 = 20B

Corrente:

Largura interna: 19,05

Diâmetro do rolo: 19,05

Engrenagens:

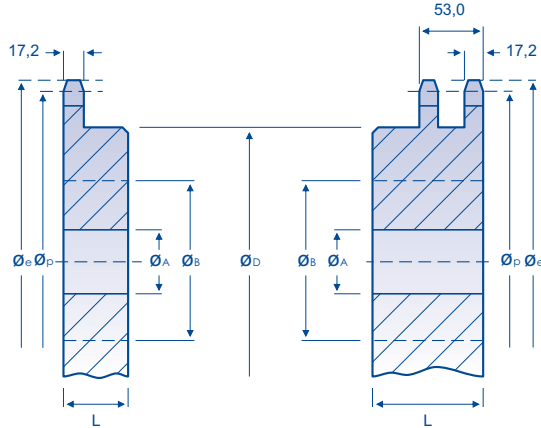

Corrente:

Largura interna: 19,56

Diâmetro do rolo: 19,05

Engrenagens:

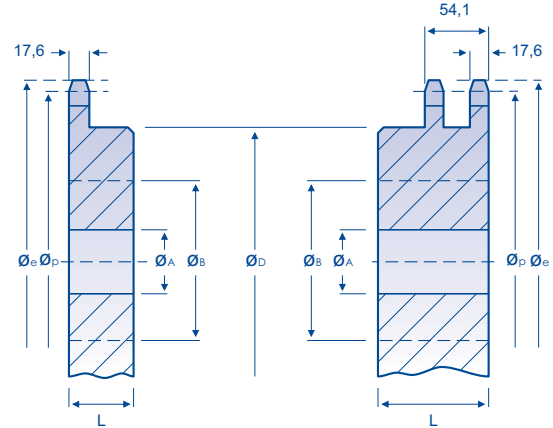

Nº de dentes Z	Diâmetro Primitivo \varnothing_p	Diâmetro Externo \varnothing_e	\varnothing_A	\varnothing_B	\varnothing_D	Simples		Dupla		Nº de dentes Z	Diâmetro Primitivo \varnothing_p	Diâmetro Externo \varnothing_e	\varnothing_A	\varnothing_B	\varnothing_D	Simples		Dupla	
						L	Tipos	L	Tipos							L	Tipos	L	Tipos
008	82,96	93,0	20	30	45	35	2-3	60	2-3	036	364,29	378,0	35	83	124	56	4-5	75	4-5
009	92,83	103,0	20	36	55	35	2-3	60	2-3	037	374,38	388,0	35	83	124	56	4-5	75	4-5
010	102,74	113,0	25	44	66	40	2-3	70	2-3	038	384,48	398,0	35	83	124	56	4-5	75	4-5
011	112,70	123,0	25	51	77	40	2-3	70	2-3	039	394,57	408,0	35	83	124	56	4-5	75	4-5
012	122,67	133,0	25	58	87	40	2-3	70	2-3	040	404,67	418,0	35	83	124	56	4-5	80	4-5
013	132,67	145,0	30	65	98	40	2-3	70	2-3	041	414,76	429,0	35	83	124	56	4-5	80	4-5
014	142,68	155,0	30	71	106	40	2-3	70	2-3	042	424,86	439,0	35	83	124	56	4-5	80	4-5
015	152,71	165,0	30	77	116	40	2-3	70	2-3	043	434,96	449,0	35	83	124	56	4-5	80	4-5
016	162,74	175,0	30	65	98	45	4-5	75	4-5	044	445,06	459,0	35	83	124	56	4-5	80	4-5
017	172,79	185,0	30	65	98	45	4-5	75	4-5	045	455,15	469,0	40	83	124	56	4-5	80	4-5
018	182,84	195,0	30	73	110	45	4-5	75	4-5	046	465,25	479,0	40	83	124	56	4-5	80	4-5
019	192,90	205,0	30	73	110	45	4-5	75	4-5	047	475,35	489,0	40	83	124	56	4-5	80	4-5
020	202,96	215,0	30	73	110	45	4-5	75	4-5	048	485,45	499,0	40	90	136	56	4-5	80	4-5
021	213,03	225,0	30	73	110	45	4-5	75	4-5	049	495,55	509,0	40	90	136	56	4-5	80	4-5
022	223,10	235,0	30	73	110	45	4-5	75	4-5	050	505,65	519,0	40	90	136	56	4-5	80	4-5
023	233,17	245,0	35	73	110	50	4-5	75	4-5	051	515,75	530,0	40	90	136	56	4-5	80	4-5
024	243,25	255,0	35	73	110	50	4-5	75	4-5	052	525,85	540,0	40	90	136	56	4-5	80	4-5
025	253,33	265,0	35	73	110	50	4-5	75	4-5	053	535,95	550,0	40	90	136	56	4-5	80	4-5
026	263,40	277,0	35	73	110	50	4-5	75	4-5	054	546,05	560,0	40	90	136	65	4-5	80	4-5
027	273,49	287,0	35	73	110	50	4-5	75	4-5	055	556,15	570,0	40	90	136	65	4-5	80	4-5
028	283,57	297,0	35	83	124	50	4-5	75	4-5	056	566,25	580,0	40	90	136	65	4-5	80	4-5
029	293,66	307,0	35	83	124	50	4-5	75	4-5	057	576,35	590,0	40	90	136	65	4-5	80	4-5
030	303,75	317,0	35	83	124	56	4-5	75	4-5	058	586,45	600,0	40	90	136	65	4-5	80	4-5
031	313,83	328,0	35	83	124	56	4-5	75	4-5	059	596,55	610,0	40	90	136	65	4-5	80	4-5
032	323,93	338,0	35	83	124	56	4-5	75	4-5	060	606,66	620,0	40	90	136	65	4-5	80	4-5
033	334,01	348,0	35	83	124	56	4-5	75	4-5	061	616,76	630,0	40	90	136	65	4-5	80	4-5
034	344,10	358,0	35	83	124	56	4-5	75	4-5	076	768,30	782,0	40	100	150	65	4-5	80	4-5
035	354,20	368,0	35	83	124	56	4-5	75	4-5										

Norma ASA 120

Norma DIN 120 = 24B

Corrente:

Largura interna: 25,40

Diâmetro do rolo: 22,22

Engrenagens:

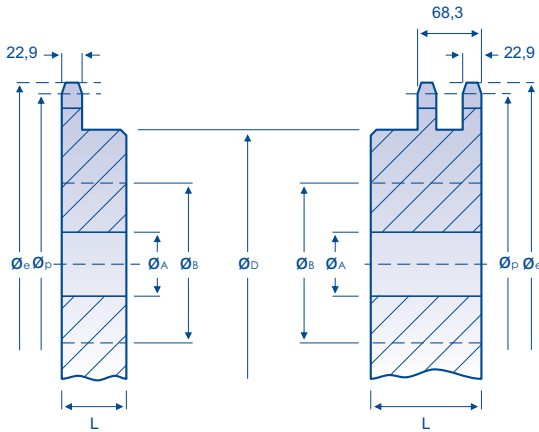

Corrente:

Largura interna: 25,40

Diâmetro do rolo: 25,40

Engrenagens:

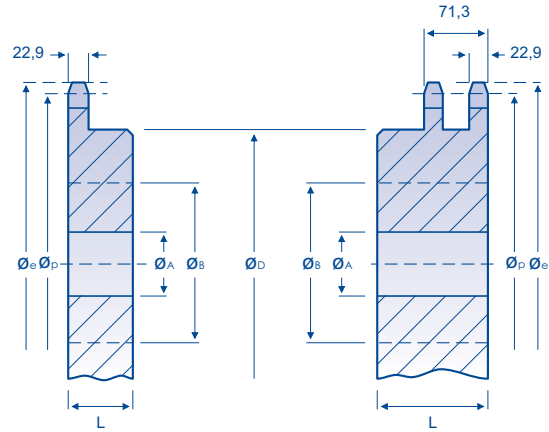

Nº de dentes	Diâmetro Primitivo	Diâmetro Externo	Ø _A	Ø _B	Ø _D	Simples		Dupla		Nº de dentes	Diâmetro Primitivo	Diâmetro Externo	Ø _A	Ø _B	Ø _D	Simples		Dupla	
						L	Tipos	L	Tipos							L	Tipos	L	Tipos
Z	Ø _p	Ø _e								Z	Ø _p	Ø _e							
008	99,56	113,0	25	35	53	45	2-3	80	2-3	031	376,60	395,0	40	83	124	55	4-5	90	4-5
009	111,40	125,0	25	43	65	45	2-3	80	2-3	032	388,71	407,0	40	83	124	55	4-5	90	4-5
010	123,29	136,0	30	52	78	50	2-3	90	2-3	033	400,82	419,0	40	83	124	55	4-5	90	4-5
011	135,23	148,0	35	61	91	50	2-3	90	2-3	034	412,93	431,0	40	83	124	55	4-5	90	4-5
012	147,21	160,0	35	69	103	50	2-3	90	2-3	035	425,03	443,0	40	83	124	55	4-5	90	4-5
013	159,20	175,0	35	65	98	50	4-5	-	-	036	437,15	455,0	40	83	124	55	4-5	90	4-5
013	159,20	175,0	35	77	115	-	-	90	2-3	037	449,26	467,0	40	83	124	55	4-5	90	4-5
014	171,22	187,0	35	65	98	50	4-5	90	4-5	038	461,37	479,0	40	90	136	55	4-5	95	4-5
015	183,25	199,0	35	73	110	50	4-5	90	4-5	039	473,49	492,0	40	90	136	55	4-5	95	4-5
016	195,29	211,0	35	73	110	50	4-5	90	4-5	040	485,60	504,0	40	90	136	60	4-5	95	4-5
017	207,35	223,0	35	73	110	55	4-5	90	4-5	041	497,72	516,0	40	90	136	60	4-5	95	4-5
018	219,41	235,0	35	73	110	55	4-5	90	4-5	042	509,83	528,0	40	90	136	60	4-5	95	4-5
019	231,48	247,0	35	73	110	55	4-5	90	4-5	043	521,95	540,0	40	90	136	60	4-5	95	4-5
020	243,55	259,0	35	73	110	55	4-5	90	4-5	044	534,07	552,0	40	90	136	60	4-5	95	4-5
021	255,63	271,0	35	73	110	55	4-5	90	4-5	045	546,16	564,0	40	90	136	60	4-5	95	4-5
022	267,72	283,0	35	83	124	55	4-5	90	4-5	046	558,30	576,0	40	90	136	60	4-5	95	4-5
023	279,80	295,0	35	83	124	55	4-5	90	4-5	047	570,42	589,0	40	90	136	60	4-5	95	4-5
024	291,90	308,0	35	83	124	55	4-5	90	4-5	048	582,54	601,0	40	90	136	60	4-5	95	4-5
025	303,99	320,0	40	83	124	55	4-5	90	4-5	049	594,66	613,0	40	90	136	60	4-5	95	4-5
026	316,09	334,0	40	83	124	55	4-5	90	4-5	050	606,78	625,0	40	90	136	60	4-5	95	4-5
027	328,19	346,0	40	83	124	55	4-5	90	4-5	054	655,26	673,0	40	90	136	60	4-5	95	4-5
028	340,29	358,0	40	83	124	55	4-5	90	4-5	057	691,62	710,0	40	90	136	60	4-5	95	4-5
029	352,39	370,0	40	83	124	55	4-5	90	4-5	060	727,99	746,0	40	100	150	60	4-5	95	4-5
030	364,49	383,0	40	83	124	55	4-5	90	4-5										

Corrente:

Largura interna: 25,40

Diâmetro do rolo: 25,40

Engrenagens:

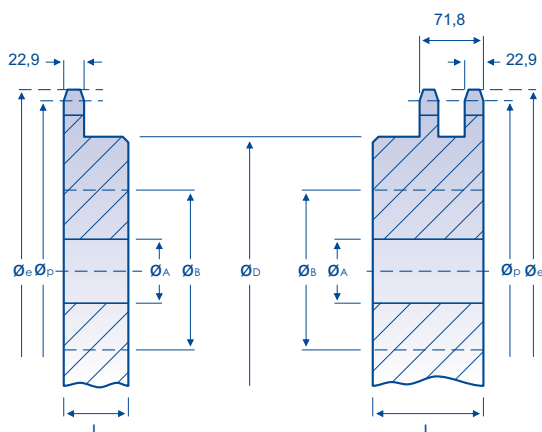

Corrente:

Largura interna: 30,99

Diâmetro do rolo: 27,94

Engrenagens:

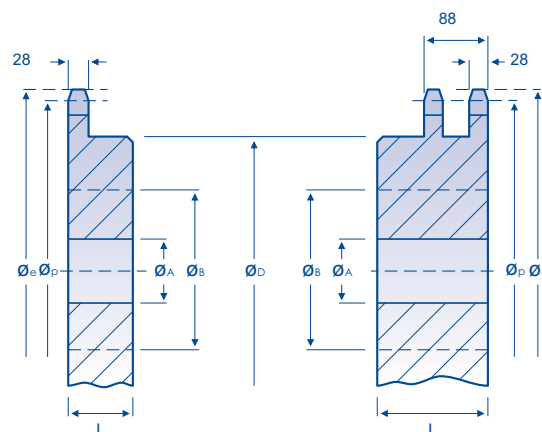

Nº de dentes Z	Diâmetro Primitivo Ø _p	Diâmetro Externo Ø _e	Ø _A	Ø _B	Ø _D	Simples		Dupla		Nº de dentes Z	Diâmetro Primitivo Ø _p	Diâmetro Externo Ø _e	Ø _A	Ø _B	Ø _D	Simples		Dupla	
						L	Tipos	L	Tipos							L	Tipos	L	Tipos
11	157,77	178,10	45	65	98	50	4-5	96	4-5	27	382,88	407,00	45	90	136	60	4-5	100	4-5
12	171,74	192,60	45	65	98	50	4-5	96	4-5	28	397,00	421,20	45	90	136	60	4-5	100	4-5
13	185,74	207,00	45	73	110	55	4-5	96	4-5	29	411,12	435,38	45	90	136	60	4-5	100	4-5
14	199,76	221,00	45	73	110	55	4-5	96	4-5	30	425,24	450,00	45	90	136	60	4-5	100	4-5
15	213,79	236,00	45	73	110	55	4-5	96	4-5	31	439,36	463,80	45	90	136	60	4-5	100	4-5
16	227,84	250,00	45	73	110	55	4-5	96	4-5	32	453,49	478,00	45	90	136	60	4-5	100	4-5
17	241,91	264,00	45	73	110	55	4-5	96	4-5	33	467,61	492,20	45	100	150	70	4-5	100	4-5
18	255,98	279,00	45	73	110	55	4-5	96	4-5	34	481,74	506,40	45	100	150	70	4-5	100	4-5
19	270,06	293,00	45	83	124	55	4-5	96	4-5	35	495,88	521,00	45	100	150	70	4-5	100	4-5
20	284,14	307,00	45	83	124	55	4-5	96	4-5	36	510,00	534,70	45	100	150	70	4-5	100	4-5
21	298,24	322,00	45	83	124	55	4-5	96	4-5	37	524,13	548,90	45	100	150	70	4-5	100	4-5
22	312,34	336,00	45	83	124	55	4-5	96	4-5	38	538,27	563,00	45	100	150	70	4-5	100	4-5
23	326,44	350,00	45	90	136	60	4-5	100	4-5	39	552,40	577,30	45	100	150	70	4-5	100	4-5
24	340,55	364,00	45	90	136	60	4-5	100	4-5	40	566,54	591,00	45	100	150	70	4-5	100	4-5
25	354,66	378,50	45	90	136	60	4-5	100	4-5	41	580,67	605,60	45	100	150	70	4-5	100	4-5
26	368,77	393,00	45	90	136	60	4-5	100	4-5	42	594,80	619,80	45	100	150	70	4-5	100	4-5

Corrente:

Largura interna: 31,75

Diâmetro do rolo: 28,58

Corrente:

Largura interna: 30,99

Diâmetro do rolo: 29,21

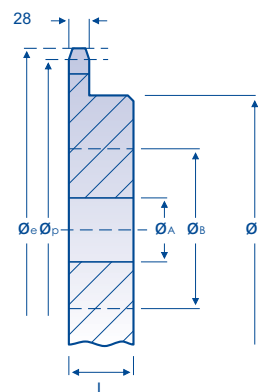
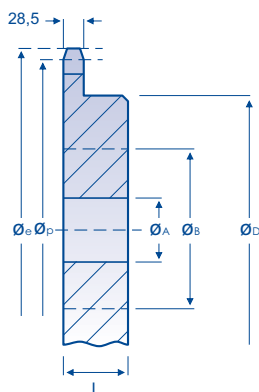

Nº de dentes Z	Diâmetro Primitivo \varnothing_p	Diâmetro Externo \varnothing_e	\varnothing_A	\varnothing_B	\varnothing_D	Simples	
						L	Tipos
11	177,87	204	45	65	98	58	1,4,5
12	196,28	220	45	65	110	58	1,4,5
13	212,27	237	45	73	110	58	1,4,5
14	228,29	253	45	83	124	60	1,4,5
15	244,33	269	45	83	124	60	1,4,5
16	260,39	286	45	83	124	60	1,4,5
17	276,46	302	45	90	136	64	1,4,5
18	292,55	319	45	90	136	64	1,4,5
19	308,64	335	45	90	136	64	1,4,5
20	324,74	351	45	90	136	64	1,4,5
21	340,84	368	45	90	136	64	1,4,5
22	356,96	384	45	90	136	64	1,4,5
23	373,07	400	45	100	150	70	1,4,5
24	389,19	416	45	100	150	70	1,4,5
25	405,32	433	45	100	150	70	1,4,5
30	485,99	514	45	100	150	70	1,4,5

Norma ASA 2040

Corrente:

Largura interna: 7,95

Diâmetro do rolo: 7,94

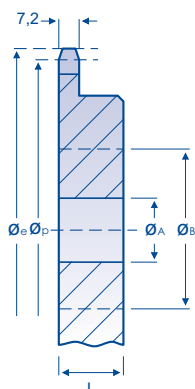

Nº de dentes Z	Diâmetro Primitivo Ø _p	Diâmetro Externo Ø _e	Ø _A	Ø _B	Ø _D	Simples		Nº de dentes Z	Diâmetro Primitivo Ø _p	Diâmetro Externo Ø _e	Ø _A	Ø _B	Ø _D	Simples	
						L	Tipos							L	Tipos
009	73,14	79,0	17	39	59	25	2-3	043	347,74	354,0	25	65	98	36	4-5
010	81,18	87,0	17	45	67	25	2-3	044	355,82	362,0	25	65	98	36	4-5
011	89,24	95,0	17	50	75	30	2-3	045	363,90	370,0	25	65	98	36	4-5
012	97,30	103,0	17	55	83	30	2-3	046	371,99	378,0	25	65	98	36	4-5
013	105,36	112,0	17	61	92	30	2-3	047	380,07	386,0	25	65	98	36	4-5
014	113,43	120,0	17	63	95	30	2-3	048	388,15	394,0	25	65	98	36	4-5
015	121,50	128,0	17	67	100	30	2-3	049	396,24	402,0	25	65	98	36	4-5
016	129,57	136,0	20	67	100	30	2-3	050	404,32	411,0	25	65	98	36	4-5
017	137,64	144,0	20	67	100	30	2-3	051	412,40	418,0	25	65	98	36	4-5
018	145,72	152,0	20	57	86	32	4-5	052	420,49	427,0	25	65	98	36	4-5
019	153,79	160,0	20	57	86	32	4-5	053	428,57	435,0	25	65	98	36	4-5
020	161,87	168,0	20	57	86	36	4-5	054	436,66	443,0	25	65	98	36	4-5
021	169,94	176,0	20	57	86	36	4-5	055	444,74	451,0	25	65	98	36	4-5
043	173,98	180,0	20	57	86	36	4-5	056	452,82	459,0	25	65	98	36	4-5
022	178,02	184,0	20	57	86	36	4-5	057	460,91	467,0	25	73	110	36	4-5
045	182,06	188,0	20	57	86	36	4-5	058	468,99	475,0	25	73	110	36	4-5
023	186,10	192,0	20	57	86	36	4-5	059	477,08	483,0	25	73	110	36	4-5
024	194,18	200,0	25	57	86	36	4-5	060	485,16	491,0	25	73	110	36	4-5
025	202,26	208,0	25	57	86	36	4-5	061	493,24	499,0	25	73	110	36	4-5
026	210,34	217,0	25	57	86	36	4-5	062	501,33	507,0	25	73	110	36	4-5
027	218,42	225,0	25	57	86	36	4-5	063	509,41	515,0	25	73	110	36	4-5
028	226,50	233,0	25	57	86	36	4-5	064	517,50	524,0	25	73	110	36	4-5
029	234,58	241,0	25	65	98	36	4-5	065	525,58	532,0	25	73	110	36	4-5
030	242,66	249,0	25	65	98	36	4-5	066	533,67	540,0	25	73	110	36	4-5
031	250,74	257,0	25	65	98	36	4-5	067	541,75	548,0	25	73	110	36	4-5
032	258,83	265,0	25	65	98	36	4-5	068	549,83	556,0	25	73	110	36	4-5
033	266,91	273,0	25	65	98	36	4-5	069	557,92	564,0	25	73	110	36	4-5
034	274,99	281,0	25	65	98	36	4-5	070	566,00	572,0	25	73	110	36	4-5
035	283,07	289,0	25	65	98	36	4-5	071	574,09	580,0	25	73	110	36	4-5
036	291,15	297,0	25	65	98	36	4-5	072	582,17	588,0	25	73	110	36	4-5
037	299,24	305,0	25	65	98	36	4-5	073	590,26	596,0	25	73	110	36	4-5
038	307,32	314,0	25	65	98	36	4-5	074	598,34	604,0	25	73	110	36	4-5
039	315,40	322,0	25	65	98	36	4-5	075	606,42	612,0	25	73	110	36	4-5
040	323,49	330,0	25	65	98	36	4-5	076	614,51	621,0	25	73	110	36	4-5
041	331,57	338,0	25	65	98	36	4-5	077	622,59	629,0	25	73	110	36	4-5
042	339,65	346,0	25	65	98	36	4-5								

Corrente:

Largura interna: 9,53

Diâmetro do rolo: 10,16

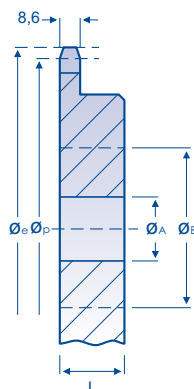

Nº de dentes Z	Diâmetro Primitivo Ø _p	Diâmetro Externo Ø _e	Ø _A	Ø _B	Ø _D	Simples		Nº de dentes Z	Diâmetro Primitivo Ø _p	Diâmetro Externo Ø _e	Ø _A	Ø _B	Ø _D	Simples	
						L	Tipos							L	Tipos
008	81,37	88,0	17	43	64	25	2-3	036	363,94	371,0	25	65	98	40	4-5
009	31,42	98,0	17	49	74	25	2-3	037	374,05	382,0	25	65	98	40	4-5
010	101,48	108,0	20	56	84	30	2-3	038	384,15	392,0	30	65	98	40	4-5
011	111,55	118,0	20	63	94	30	2-3	039	394,25	402,0	30	65	98	40	4-5
012	121,62	128,0	20	67	100	34	2-3	040	404,36	412,0	30	65	98	40	4-5
013	131,70	139,0	20	73	110	34	2-3	041	414,46	422,0	30	65	98	40	4-5
014	141,79	149,0	20	57	86	37	4-5	042	424,57	432,0	30	65	98	40	4-5
015	151,87	159,0	20	57	86	37	4-5	043	434,67	442,0	30	65	98	40	4-5
016	161,96	169,0	20	57	86	37	4-5	044	444,77	452,0	30	65	98	40	4-5
017	172,05	180,0	20	57	86	37	4-5	045	454,88	462,0	30	65	98	40	4-5
018	182,14	190,0	20	57	86	37	4-5	046	464,98	473,0	30	65	98	40	4-5
019	192,24	200,0	25	57	86	37	4-5	047	475,09	483,0	30	65	98	40	4-5
020	202,33	210,0	25	57	86	40	4-5	048	485,19	493,0	30	65	98	40	4-5
021	212,43	220,0	25	57	86	40	4-5	049	495,30	503,0	30	65	98	40	4-5
022	222,53	230,0	25	57	86	40	4-5	050	505,40	513,0	30	73	110	40	4-5
023	232,63	240,0	25	57	86	40	4-5	051	515,50	523,0	30	73	110	40	4-5
024	242,73	250,0	25	65	98	40	4-5	052	525,61	533,0	30	73	110	40	4-5
025	252,82	260,0	25	65	98	40	4-5	053	535,71	543,0	30	73	110	40	4-5
026	262,92	270,0	25	65	98	40	4-5	054	545,82	553,0	30	73	110	40	4-5
027	273,03	280,0	25	65	98	40	4-5	055	555,92	564,0	30	73	110	40	4-5
028	283,13	291,0	25	65	98	40	4-5	056	566,03	574,0	30	73	110	40	4-5
029	293,23	301,0	25	65	98	40	4-5	057	576,13	584,0	30	73	110	40	4-5
030	303,33	311,0	25	65	98	40	4-5	058	586,24	594,0	30	73	110	40	4-5
031	313,43	321,0	25	65	98	40	4-5	059	596,34	604,0	30	73	110	40	4-5
032	323,53	331,0	25	65	98	40	4-5	060	606,45	614,0	30	73	110	40	4-5
033	333,63	341,0	25	65	98	40	4-5	061	616,55	624,0	30	73	110	40	4-5
034	343,74	351,0	25	65	98	40	4-5	062	626,66	634,0	30	73	110	40	4-5
035	353,84	361,0	25	65	98	40	4-5								

Corrente:

Largura interna: 12,7

Diâmetro do rolo: 11,9

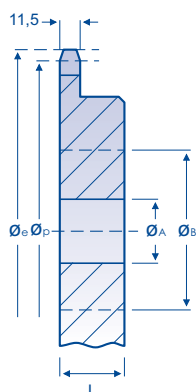

Nº de dentes	Diâmetro Primitivo	Diâmetro Externo	Ø _A	Ø _B	Ø _D	Simples		Nº de dentes	Diâmetro Primitivo	Diâmetro Externo	Ø _A	Ø _B	Ø _D	Simples	
						L	Tipos							Z	Tipos
008	97,65	105,0	20	51	77	30	2-3	030	363,99	373,0	30	83	124	45	4-5
009	109,71	117,0	20	60	90	30	2-3	031	376,12	385,0	30	83	124	45	4-5
010	121,78	129,0	20	67	100	36	2-3	032	388,24	397,0	30	83	124	45	4-5
011	133,86	141,0	25	75	113	36	2-3	033	400,36	409,0	30	83	124	45	4-5
012	145,95	153,0	25	65	98	39	4-5	034	412,48	421,0	30	83	124	45	4-5
013	158,04	167,0	25	65	98	39	4-5	035	424,61	433,0	30	83	124	45	4-5
014	170,14	179,0	25	65	98	39	4-5	036	436,73	446,0	30	83	124	45	4-5
015	182,25	191,0	25	65	98	39	4-5	037	448,86	458,0	30	83	124	45	4-5
016	194,35	203,0	25	65	98	39	4-5	038	460,98	470,0	30	83	124	45	4-5
017	206,46	215,0	25	65	98	39	4-5	039	473,10	482,0	30	83	124	45	4-5
018	218,57	227,0	25	65	98	39	4-5	040	485,23	494,0	30	83	124	45	4-5
019	230,69	239,0	30	65	98	45	4-5	041	497,35	506,0	30	83	124	45	4-5
020	242,80	252,0	30	65	98	45	4-5	042	509,48	518,0	30	83	124	45	4-5
021	254,96	264,0	30	65	98	45	4-5	043	521,6	530,0	30	83	124	45	4-5
022	267,03	276,0	30	65	98	45	4-5	044	533,73	543,0	30	83	124	45	4-5
023	279,15	288,0	30	73	110	45	4-5	045	545,85	555,0	30	83	124	45	4-5
024	291,21	300,0	30	83	124	45	4-5	046	557,98	567,0	30	83	124	45	4-5
025	303,39	312,0	30	83	124	45	4-5	047	570,10	579,0	30	83	124	45	4-5
026	315,51	324,0	30	83	124	45	4-5	048	582,23	591,0	30	83	124	45	4-5
027	327,63	336,0	30	83	124	45	4-5	049	594,35	603,0	30	83	124	45	4-5
028	339,75	348,0	30	83	124	45	4-5	050	606,48	615,0	30	83	124	45	4-5
029	351,87	361,0	30	83	124	45	4-5	051	618,61	627,0	30	83	124	45	4-5

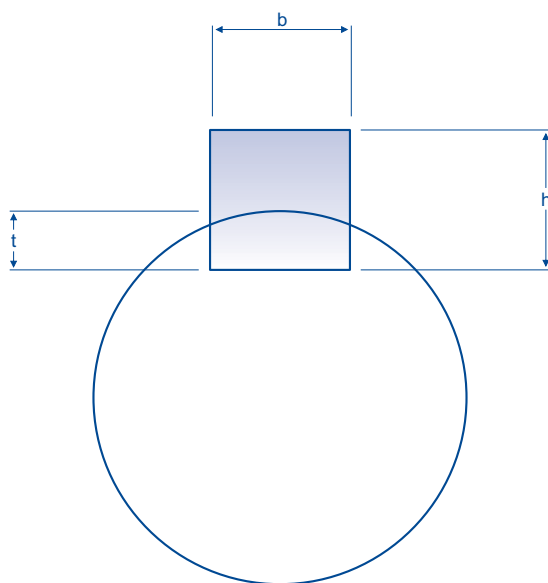

Diâmetro do Eixo	Largura	Altura	Profundidade no Eixo	Profundidade na Engrenagem
d	b	h	t	t
10 - 12	4	4	2,5	1,7
13 - 17	5	5	3	2,2
18 - 22	6	6	3,5	2,7
23 - 30	8	7	4	3,2
31 - 38	10	8	4,5	3,7
39 - 44	12	8	4,5	3,7
45 - 50	14	9	5	4,2
51 - 58	16	10	5	5,2
59 - 68	18	11	6	5,3
69 - 78	20	12	6	6,3
79 - 92	24	14	7	7,3
93 - 110	28	16	8	8,3
111 - 130	32	18	9	9,3
131 - 150	36	20	10	10,3

Eixo Padrão

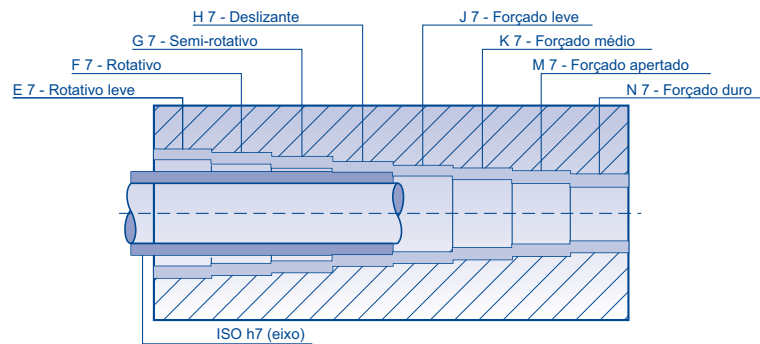

Ø em mm	Qualidade 6						Qualidade 7									
	G 6	H 6	J 6	K 6	M 6	N 6	E 7	F 7	G 7	H 7	J 7	K 7	M 7	N 7	P 7	
até 3	+3	0	-4		-7	-11	+14	+7	+3	0	-6		-9	-13	-16	
	+10	+7	+3		0	-4	+23	+16	+12	+9	+3		0	-4	-7	
acima de 3	+4	0	-4		-9	-13	+20	+10	+4	0	-7		-12	-16	-20	
até 6	+12	+8	+4		-1	-5	+32	+22	+16	+12	+5		0	-4	-8	
acima de 6	+5	0	-4	-7	-12	-16	+25	+13	+5	0	-7	-10	-15	-19	-24	
até 10	+14	+9	+5	+2	-3	-7	+40	+28	+20	+15	+8	+5	0	-4	-9	
acima de 10	+6	0	-5	-9	-15	-20	+32	+16	+6	0	-8	-12	-18	-23	-29	
até 18	+17	+11	+6	+2	-4	-9	+50	+34	+24	+18	+10	+6	0	-5	-11	
acima de 18	+7	0	-5	-11	-17	-24	+40	+20	+7	0	-9	-15	-21	-28	-35	
até 30	+20	+13	+8	+2	-4	-11	+61	+41	+28	+21	+12	+6	0	-7	-14	
acima de 30	+9	0	-6	-13	-20	-28	+50	+25	+9	0	-11	-18	-25	-33	-42	
até 50	+25	+16	+10	+3	-4	-12	+75	+50	+34	+25	+14	+7	0	-8	-17	
acima de 50	+10	0	-6	-15	-24	-33	+60	+30	+10	0	-12	-21	-30	-39	-51	
até 80	+29	+19	+13	+4	-5	-14	+90	+60	+40	+30	+18	+9	0	-9	-21	
acima de 80	+12	0	-6	-18	-28	-38	+72	+36	+12	0	-13	-25	-35	-45	-59	
até 120	+34	+22	+16	+4	-6	-16	+107	+71	+47	+35	+22	+10	0	-10	-24	
acima de 120	+14	0	-7	-21	-33	-45	+85	+43	+14	0	-14	-28	-40	-52	-68	
até 180	+39	+25	+18	+4	-8	-20	+125	+83	+54	+40	+26	+12	0	-12	-28	

Ø em mm	Qualidade 8								Qualidade 9				Qualidade 10			Qualidade 11		
	D 8	E 8	F 8	H 8	J 8	K 8	M 8	N 8	D 9	E 9	H 9	J 9	D 10	H 10	J 10	D 11	H 11	J 11
até 3	+20	+14	+7	0	-7			-15	+20	+14	0	-13	+20	0	-20	+20	0	-30
	+34	+28	+21	+14	+7			-1	+45	+39	+25	+12	+60	+40	+20	+80	+60	+30
acima de 3	+30	+20	+10	0	-9			-20	+30	+20	0	-15	+30	0	-24	+30	0	-38
até 6	+48	+38	+28	+18	+9			-2	+60	+50	+30	+15	+78	+48	+24	+105	+75	+37
acima de 6	+40	+25	+13	0	-10	-16	-21	-25	+40	+25	0	-18	+40	0	-29	+40	0	-45
até 10	+62	+47	+35	+22	+12	+6	+1	-3	+76	+61	+36	+18	+98	+58	+29	+130	+90	+45
acima de 10	+50	+32	+16	0	-12	-19	-25	-30	+50	+32	0	-22	+50	0	-35	+50	0	-55
até 18	+77	+59	+43	+27	+15	+8	+2	-3	+93	+75	+43	+21	+120	+70	+35	+160	+110	+55
acima de 18	+65	+40	+20	0	-13	-23	-29	-36	+65	+40	0	-26	+65	0	-42	+65	0	-65
até 30	+98	+73	+53	+33	+20	+10	+4	-3	+117	+92	+52	+26	+149	+84	+42	+195	+130	+65
acima de 30	+80	+50	+25	0	-15	-27	-34	-42	+80	+50	0	-31	+80	0	-50	+80	0	-80
até 50	+119	+89	+64	+39	+24	+12	+5	-3	+142	+112	+62	+31	+180	+100	+50	+240	+160	+80
acima de 50	+100	+60	+30	0	-18	-32	-41	-50	+100	+60	0	-37	+100	0	-60	+100	0	-95
até 80	+146	+106	+76	+46	+28	+14	+5	-4	+174	+134	+74	+37	+220	+120	+60	+290	+190	+95
acima de 80	+120	+72	+36	0	-20	-38	-48	-58	+120	+72	0	-44	+120	0	-70	+120	0	-110
até 120	+174	+125	+90	+54	+34	+16	+6	-4	+207	+159	+87	+43	+260	+140	+70	+340	+220	+110
acima de 120	+145	+85	+43	0	-22	-43	-55	-67	+145	+85	0	-50	+145	0	-80	+145	0	-125
até 180	+208	+148	+106	+63	+41	+20	+8	-4	+245	+185	+100	+50	+305	+160	+80	+395	+250	+125

Tolerâncias em µ (micron)



Idema Peças e Máquinas Agrícolas Ltda.

Av. Prefeito Evandro Behr, nº 5200 - Camobi

+ 55 55 3226-1163 - Santa Maria - RS

vendas@idema.com.br - www.idema.com.br

Empresa certificada pela ISO 9001/2015

